

The logo for Jo/ke, featuring the letters 'Jo' in a blue box and 'ke' in white on a blue background, with a vertical line separating them.

Jo/ke

The text 'mikromat 50 eco' is printed in white on the blue metal surface of the machine.

mikromat 50 eco



Instruction manual

mikromat 50 eco

Fine Dry Blasting Unit

Order-No.: 0 951 100-8



Oberflächentechnik
Surface Technology



Visit us on the Internet at www.joke-technology.de

DRIVESPOLISHING
GRINDING
DIAMOND/CBN
MILLING
DEBURRING
WELDING
CLEANING
BLASTING
WORKPLACE
TRAINING PROGRAMMES

Brief instructions

Filling with blasting shot

1. Open the flap door of the blasting cabin.
2. If necessary, lift the front section of the perforated base plate over the running-off and storage container and place it on the rear perforated base plate.
3. Now fill the storage container with blasting shot as required.

Starting the blasting process

1. Ensure that blasting shot is present in the running-off and storage container of the blasting cabin according to your requirements. Top up with blasting shot if necessary.
2. Ensure that the blasting cabin is supplied with compressed air.
3. Switch on the light and aspiration.
4. Open the door of the blasting cabin.
5. Place the workpiece to be processed in the blasting cabin and close the door.
6. Check that the viewing window is in perfect condition before beginning blasting work.
7. Put on blasting protection gloves.
8. Subsequently operate the foot switch to start the blasting process.
9. Adjust the air pressure if required at the adjustment wheel of the compressed air connection unit.

Stopping the blasting process

1. Once blasting work is completed, remove your foot from the foot switch.
2. The blasting process is halted.
3. Wait for a further brief period until the dust-laden air has been sucked out of the blasting chamber. Subsequently open the door and remove the processed workpiece.
4. Close the door.

1**List of contents**

	Brief instructions	Page 03
1	Inhaltsverzeichnis	Page 04
2	Tips on using the manual	Page 04
3	Safety instructions	Page 05
4	Warranty	Page 07
5	Use	Page 07
6	Inbetriebnahme	Page 08
7	Technical data	Page 13
8	Hinweise zum Strahlmittel	Page 14
9	Troubleshooting	Page 15
10	Pflege/Wartung	Page 17
11	List of spare parts	Page 21
12	Conformity declaration	Page 23

2**Tips on using the manual**

We congratulate you on purchasing this device.

This manual has been written for the device user to ensure a problem-free operation, care and maintenance. Important instructions and information concerning safety and operational reliability have been highlighted.

The symbols used in the manual have the following meanings:



Working and operating processes which must be observed to the letter to exclude any risk to persons and avoid damage to the device.



Technical information to which the device operator must give special attention.

The illustrations and diagrams are numbered in sequence within each chapter. Some of these illustrations have keys. References to illustrations within the text e. g. (5.1/2) have the following meaning:

5.1 = Figure 5.1

2 = Position 2 in the key to the figure.

Our service department is available at all times in case of technical problems not addressed in this manual:

Telephone	+49 (0) 22 04 / 8 39 - 0
Fax	+49 (0) 22 04 / 8 39 - 60
Email	info@joke.de
Web	www.joke.de
Online-Shop	www.joke-technology.de

Safety instructions

This device has been built according to the latest technical standards and generally accepted safety regulations. Nevertheless, it can constitute a risk to the operator or third parties and a hazard to the device itself or other equipment during use.

1. Only use the device if in perfect working order and for its intended purpose. You must always pay attention to the instruction manual and safety instructions therein and be aware of the risks! Repair any faults which could affect the device's safety immediately by yourself or have these repaired.

The device is intended exclusively for fine dry blasting of workpieces made of metal, non-ferrous metals and plastics. Any other use will be deemed to be contrary to its intended purpose. The manufacturer cannot be held liable for any resulting damages. The risk is borne solely by the user.

Correct use also includes compliance with the instruction manual and an observation of the care and maintenance conditions.

2. Keep the instruction manual handy at the device's place of use.
3. Pay attention to and observe generally applicable statutory and otherwise binding regulations relating to accident prevention and environmental protection in addition to the information provided in the instruction manual!
4. All personnel commissioned to work on or with the device must have read this instruction manual, and particularly the safety instructions chapter, before starting work. This applies especially for personnel who only work with the device occasionally.
5. Stop the device immediately should you notice changes to the device or its operating behaviour that are relevant to its safety. Have these remedied before restarting work.
6. Observe safety instructions on the device and ensure they remain legible.
7. Stop and secure the device immediately in the event of malfunctions! Faults must be remedied at once.
8. Do not carry out any modifications, additions or conversions to the device! This also applies to the installation and adjustment of safety equipment.
9. Spare parts must meet the technical requirements specified by the manufacturer. This can only be guaranteed with original joke spare parts.
10. Any work on/with the device may only be carried out by qualified, appropriately trained and authorised personnel. Pay attention to minimum statutory age limits!
11. Personnel undergoing training or in a general apprenticeship should only be allowed to work with the machine under the constant supervision of an experienced operator!
12. Refrain from any type of work that could jeopardise your safety.



13. The device may only be used if all protective and safety equipment is in place and in proper working order.
14. Do not leave the device unattended when switched on!
15. Stop and secure the device immediately in the event of malfunctions! Faults must be remedied at once.
16. Observe processes for switching on and off and control indicators according to the instruction manual!
17. The mains cable, foot switch cable and compressed-air line must be laid so as to be tension free and not hinder the user. Nothing must be allowed to stand on the cables.
18. The device must be operated only in dry rooms and must not under any circumstances be exposed to moisture. The device has no explosion protection!
19. It is essential to observe the manufacturer's processing instructions in handling the blasting shot.
20. Working with explosive blasting shots is forbidden.
21. Workpieces that result in explosive dusts must not be processed with this unit.
22. Working with poisonous substances or blasting shots that give off poisonous substances is not allowed. Workpieces that release poisonous substances must not be processed.
23. Do not start the blasting process with the foot pedal until having locked the flap door and reaching with both hands through the hand holes.
24. End the blasting process only using the foot pedal and not by raising the flap door.
25. Do not wear any synthetic clothing on the body, in order to avoid static charge. Wear appropriate conductive working shoes. Depending on the blasting shot and weather, wear antistatic armbands earthed to the unit.
26. Do not remove blasting shot from the unit manually or by compressed air, but exclusively with aid of a tool.
27. Dispose of or replace used blasting shot environment-consciously and in accordance with regulations.
28. Immediately replace windows that are damaged or have become opaque.
29. Replace damaged gloves immediately.

4

Warranty

joke warrant the correct manufacture of every joke Technology GmbH product which is delivered in accordance with the terms of contract and delivery.

This warranty does not cover wearing parts or those carrying blasting shot and damages caused by normal wear and tear, incorrect handling, negligent use, the fitting of non-original spare parts, inadequate care and/or a failure to comply with this technical manual.



The device may only be used by appropriately trained personnel. If it is not, all warranty claims will be forfeited according to the terms of delivery.

5

Use

The device is intended for abrasive material processing by fine blasting with various blasting media. Among others, the following blasting processes are possible:

- Scale removing after hardening.
- Smoothing of plastic and diecasting moulds, compression moulding dies and embossing dies.
- Shot peening of wearing parts.
- Derusting and removing of lacquer of/from components.
- Deburring of metal components after machining (e.g. turning, drilling, milling) and of duroplastic mouldings from injection moulding and shaped casting).
- Cleaning of plastic and rubber moulds, welds and soldered parts.
- Preparation of surfaces for paint spraying, gluing and electroplating.
- Matting and brightening (decorative blasting).

The application possibilities are versatile by:

- Use of different blasting media.
- Use of different grit sizes:

The precisely balanced relationship between the dosing cup and blasting gun in addition to the special filter system allows the use of all commercially available blasting media. Grit sizes of between 1 mm (approx. 20 mesh) and 0.01 mm (approx. 400 mesh) can be processed.

6 First-time-use

Installation site

The unit must not be installed in an environment where there is a risk of explosion or in rooms with a risk of explosion.

The unit must not be installed in damp rooms or in rooms with high relative humidity.

Machine connections

Only connect the unit via a plug connector that allows disconnection from the electrical mains. The electrical connection must be made according to the details on the rating plate and this operating manual.

The compressed air supply (input pressure) must not exceed 8 bar. The unit operator must provide for a shutoff valve in the compressed air connection line on the customer's side, allowing disconnection of the unit from the supply network.

Device overview

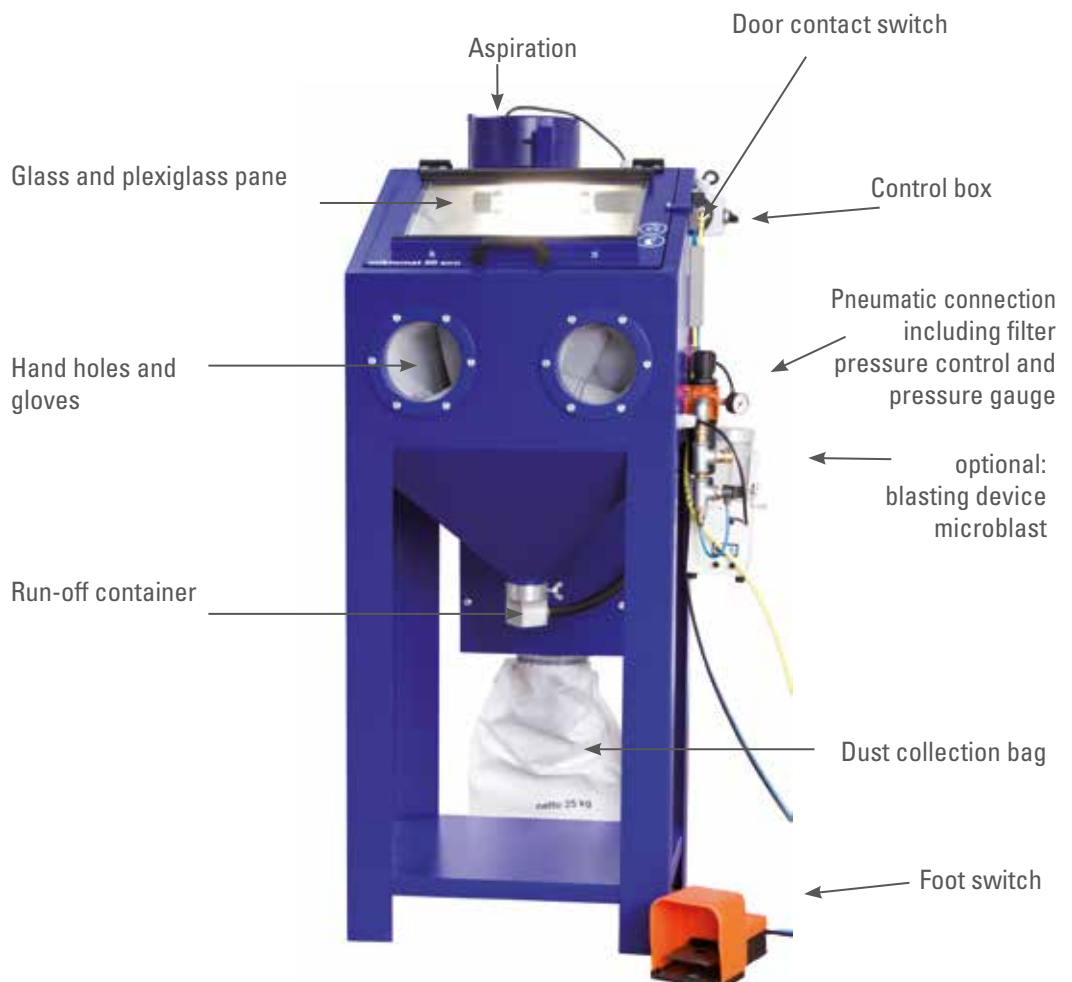

Installation and starting the unit for the first time

In order to prevent the blasting shot contained in the cabin from absorbing humidity, the unit should always be installed in a dry place. This of course also applies to the storage place of the blasting shot.

1. A water separator is incorporated in the air treatment unit in order to eliminate the water in the compressed air. Care should be taken during installation that the water separator is in the upright position.
2. Das Manometer ist auf die Luftaufbereitungseinheit geschraubt. Der Druckluftanschluss ist auf der rechten Seite der Strahlkabine unterhalb elektrischen Schaltkastens angeordnet. Mit dem Einstellrad kann der Luftdruck für Strahlkabine stufenlos eingestellt und am Manometer abgelesen werden.
3. The electrical connection is single phase, 230 V light current. The green/yellow cable forms the earth lead.
4. Switch on the aspiration device and lighting.
5. The blasting process is started by pressing the pneumatic foot switch.
6. The pneumatic foot switch operates the pneumatic valve built into the machine, which releases the compressed air to the blasting gun.
7. The safety end switch serves to interrupt the blasting process if the cabin hood is open. If the cabin is opened during blasting, the blasting process is interrupted automatically in order to avoid accidents.
8. The dosing system and run-off container is equipped with a patent quick-release lock.
9. The screws on the cabin lid secure the window frame and must be loosened in order to replace the viewing or protection pane.
10. The dust collection bag is held firmly closed by the clamping levers. If the machine is in constant use, the containers should be checked daily for overfilling.

Filling with blasting shot

1. Open the flap door of the blasting cabin.
2. If necessary, lift the front section of the perforated base plate over the running-off and storage container and place it on the rear perforated base plate.
3. Now fill the storage container with blasting shot as required.

Starting the blasting process

1. Ensure that blasting shot is present in the running-off and storage container of the blasting cabin according to your requirements. Top up with blasting shot if necessary.



Suitability of the types of blasting shot can be ordered from the current catalogue.

2. Ensure that the blasting cabin is supplied with compressed air.
3. Schalten Sie die Strahlkabine mit dem Hauptschalter am Schaltkasten ein.
4. Open the door of the blasting cabin.
5. Befestigen Sie ggf. den Strahlkopf in der Strahlkopfhalterung und ziehen Sie die Klemmschrauben fest.
6. Place the workpiece to be processed in the blasting cabin and close the door.



The blasting process cannot be started with the flap door open and with extraction switched off!

7. Check that the viewing window is in perfect condition before beginning blasting work.



**Blasting shot emerging under high pressure may cause extremely severe eye injuries!
Only operate the blasting cabin with an intact viewing window!**

Working with defective blasting protection gloves may cause purulent inflammation of hands and arms!

**Only carry out blasting work with perfect, intact authorised blasting protection gloves!
Replace damaged blasting protection gloves immediately!**

8. Put on blasting protection gloves.
9. Subsequently operate the foot switch to start the blasting process.
10. Adjust the air pressure if required at the adjustment wheel of the compressed air connection unit.

Stopping the blasting process

1. Once blasting work is completed, remove your foot from the foot switch. The blasting process is halted.
2. Wait for a further brief period until the dust-laden air has been sucked out of the blasting chamber (fan afterrun time).
3. Subsequently open the door and remove the processed workpiece.

Switching the blasting cabin off

1. Close the flap door.
2. Switch off the blasting cabin power supply, the interior lighting and the extraction at the control box using the main switch.



Bursting compressed-air lines in case of prolonged blasting cabin shutdown may cause severe damage to the entire works pneumatic system!

Always isolate the compressed-air supply at the main valve at the end of a shift or in case of prolonged blasting cabin shutdown!

3. Isolate the compressed-air supply.

Filter system

The system consists of different types of filter:

1. The air supply filter allows the air aspirated by the fan to enter the blasting chamber. Negative pressure results, which prevents the blasting shot from escaping during blasting.
2. Der Hauptfilter saugt durch die Zulufrosette Frischluft an und baut so eine Strömungsgeschwindigkeit auf. Schwebstoffe und zerschlagenes Strahlmittel kann so in die Filterpatrone gesaugt werden, bevor sie wieder in den Arbeitsraum austritt.



Only clean the filter with the fan switched off.

Changing the filter cartridges

1. Open the rear maintenance door.
2. Loosen the M10 fixing nuts under the cartridge, screw out the threaded rods and remove the cartridge.



The new filter cartridges are installed in reverse order.

Technical data

Fine blastig unit mikromat 50 eco	
Work chamber dimensions (W x D x H)	550 x 400 x approx. 250 - 350 mm
Device dimensions (W x D x H)	approx. 705 x 760 x 1,520/1,860 mm
Maße Sichtfenster	approx. 400 x 280 mm
Weight	approx. 85 kg
Anschlussspannung	230 V, 50 Hz
Tragfähigkeit Auflagerost	approx. 50 kg
Compressed-air connection thread	½"
Compressed-air control range	0.5 - 10 bars
Air consumption with blasting nozzle Ø 7 mm and air nozzle Ø 3.5 mm	max. 700 l/min. at 7 bars
Fan capacity	approx. 100 m³/h
Filter area (main filter)	4 m²
Lighting	11 W fluorescent tube

Scope of delivery

- Blasting nozzle made of hardened steel (drilling hole Ø 7 mm)
- Gloves with pair of cuffs (quick-change system)
- Compressed-air regulator with water separator
- Safety switch (no blasting shot supply with hood open)
- Foot switch for starting/stopping the blasting process.

Optional equipment

- Blow-out gun (order no. 0 952 023)
- Fine blasting unit microblast A (order no. 0 951 110-1)
- Blasting gun holder (order no. 0 952 039).

Notes concerning blasting shot

The suitable blasting shot can be found in the joke catalogue in the “cleaning and blasting equipment” chapter. Take care to use the shot in the dry state and free of lumps.

The suitable blasting shot for the various different requirements can be selected and ordered directly from joke, stating the order number.



Use of silicone-based or quartz-based blasting shot can cause extremely severe damage to the respiratory tract!

**Use of quartz-based blasting shot is prohibited!
Do not use any silicone-based blasting shot! Wear breathing protection!**

**Use of damp blasting shot or processing of wet workpieces may cause damage to the blasting cabin!
Always use dry blasting shot!
Dry wet workpieces if necessary before starting blasting work!**

Notes on blasting

It is advisable to hold the blasting gun at a distance of approx. 40 - 60 mm from the workpiece and at an angle of 45 - 60°. The gun should be passed evenly over larger areas in order to avoid cloud formation. Under certain circumstances, finally blast the entire surface again, but with a greater gun distance.

Fine profiling and sharp edges must only be blasted with fine grits and at low pressure.

If surface improvement is to be achieved, work must be performed several times with different grit sizes (from coarse to fine). The blasting shots MK 40/90, followed by MK 90/150 and finally MK 245 are recommended for this purpose. Subsequent blasting with GPF fine glass beads results in a silk gloss.

Restoration work is mainly performed at low pressure with the use of glass beads, high-grade corundum and walnut shells.

9 Troubleshooting

Malfunction	possible cause	Remedy
Excessive dust is generated	worn, damp or lumpy blasting shot	Change blasting shot
	Main filter blocked	Check whether the dust collection chamber is overfilled
		Check whether the dust collection drawer has been installed firmly sealed.
No blasting shot emerges from the blasting gun	Too little blasting shot in the cabin	Refill blasting shot
	No air pressure	Set air pressure on the pressure reducing valve to at least 1.5 bar
	Foreign bodies in the unit	Large burrs, scales and lacquer, etc. may deposit themselves in both the dosing cup and in the blasting gun. Both are to be removed by loosening the hose clamps and inspecting for foreign bodies. The air and blasting nozzle must be screwed out if necessary. The suction pipe must likewise be removed
Poor visibility in the blasting chamber	Glass pane matted by blasting shot	Replace glass pane
	Interior lighting faulty	Replace the interior lighting bulb

Malfunction	possible cause	Remedy
Aspiration output inadequate	Filter cartridge contaminated	Clean or replace the excessively contaminated filter cartridge Info: Check the filter cartridge regularly for damage and clean.
Poor blasting performance	No blasting shot or insufficient blasting shot emerges from the blasting nozzle	Initially check for the possible causes.
	Air pressure too low	Adjust the air pressure at the adjustment wheel of the compressed air connection.
	Air nozzle or blasting nozzle faulty	Replace the air nozzle or blasting nozzle
	Wrong type of blasting shot used	Adapt the blasting shot to the processed material and desired surface effect.

10 Care and maintenance

General

The care and maintenance chapter comprises the areas of care and visible inspection by the operating personnel in addition to cleaning, maintenance and repair of the joke blasting unit by specifically trained maintenance personnel. The subdivision of these areas into various maintenance intervals is intended to facilitate your scheduling of the respective necessary maintenance measures.

The instructions described in this chapter are to be regarded as minimum recommendations. Depending on the operating conditions, extensions may be necessary in order to uphold the function of the blasting cabin. The time intervals indicated refer to single-shift operation.

Please refer to the original documentation of the manufacturers of vendor parts for specific further and supplementary information - particularly regarding the vendor parts.



Danger! Risks to persons and property possible!

Personal injury and material damages occurring directly or consequentially are possible as a result of improper inspection, maintenance or repair. h.

All servicing and repair work on the blasting cabin may only be performed by qualified specialists with particular observation of the safety instructions chapter.

The regular work for maintenance and servicing must be registered in a log by the maintenance and operating personnel in order to uphold the claim under the warranty.



Only use spare parts approved by joke Technology GmbH and the latter's suppliers!

joke Technology GmbH cannot accept any liability in case of use of non-approved spare or replacement parts and utilities!

Care is to be taken to ensure environment-friendly disposal of the consumables and replacement parts.

Pay attention to proper dismantling and assembly of components in order to avoid material damage and consequential damage to the blasting cabin.

Therefore, during all dismantling and disassembly work, the following basically applies:

- Mark parts that belong together
- Mark and note the installation position and location
- Dismantle, clean and store subassemblies separately.

After repair work, the following basically applies:

- Check all screw connections for a firm seat
- Test all pipe fittings and connections for leaktightness.



If disassembly of protective devices is necessary for maintenance measures, the protective devices must be reapplied and tested immediately after completion of the work.

Operating condition

Depending on the nature and scope of the maintenance measures, the blasting cabin and the area involved must either be shut down or switched completely free of current.

In order to conduct extensive cleaning and repair measures, the blasting cabin and the area involved is to be completely disconnected from the mains power supply.



Danger! High voltage!
Results in death or life-threatening injuries.

Switch the blasting cabin free of current during extensive cleaning and maintenance work. Safeguard against being accidentally switched on again and apply a warning placard on the main switch.

Care

Only clean the device with a soft brush or dry cloth if required.
Clean the inside and outside of the window.



Do not wet clean!

All blasting cabins are exposed to major stresses and heavy soiling to a particular extent. Consequently, they require very close and regular care.

The duty of the operating personnel is to check the blasting cabin daily for wear and/or damage and report this to the competent maintenance personnel.



The inscriptions of control elements may become illegible as a result of unavoidable dirt deposits. This may result in operating errors that may cause material and consequential damages.



Material damage to the blasting cabin as a result of component contamination!

Residues may deposit themselves or penetrate into moving components.
This may cause damage to the blasting cabin!



**Always therefore check the blasting cabin at the beginning of a shift.
Clean heavily contaminated areas daily.
Switch the blasting cabin free of voltage first.
Never reach into moving machine parts with your hands!**

Daily maintenance tasks and inspections

Maintenance point	Maintenance work	Comment
Protective devices	Functional test on the protective devices	Check condition of the locking devices and contacts and clean if necessary
Entire blasting cabin	Check of operating performance	Observe all components of the blasting cabin for normal operating performance, e.g.: <ul style="list-style-type: none"> • running noises, • temperature increase, • odour development. Shut down the blasting cabin in case of irregular operating performance and immediately notify the maintenance personnel.
Entire unit	Check for residues	Check the blasting cabin and surroundings for remains of material and consumables and eliminate if necessary: <ul style="list-style-type: none"> • baked-on residues, • deposits and the like, • blasting shot residues.
Paths of travel, working surfaces, inscriptions	Eliminate contamination	Eliminate blasting shot residues around the blasting cabin.
Compressed-air supply lines, gaskets	Check	Check all movable compressed-air supply lines and gaskets, etc. Have faulty parts replaced if necessary.
Hose lines, piping, fittings, connections	Visual inspection for leaktightness	Particularly perform a control of the blasting hose and the blasting nozzle.
Protective gloves	Visual inspection for integrity	Immediately replace damaged protective gloves with new ones.



Check the filter cartridges every day. They must also be cleaned by the user once a day to ensure that the filter surface is free and absorbent again.

Weekly maintenance tasks and inspections

Maintenance point	Maintenance work	Comment
Filter bag	Empty filter bag	-

Monthly maintenance tasks and inspections

Maintenance point	Maintenance work	Comment
Pneumatic fittings	Check for free running	restore free running or replace if necessary
Electrical connections and cables	Check for damage	Have damaged connections and cables renewed by a skilled electrician if necessary

Wearing parts

Wearing parts include all components carrying blasting shot. These are preferably to be kept in stock in order to avoid unit downtimes. The wearing parts are to be separately checked every week and are also to be replaced as a precaution if necessary.

Cleaning the filter cartridges



Warning! Inhalation of respirable dusts!

May cause extremely severe respiratory tract disorders!

Wear a dust protection mask during all cleaning work!

- Switch off the unit using the main switch and safeguard the unit against being accidentally switched on again.
- Open rear filter housing.
- Next loosen the wing nuts under the filter plate.
- Check the filter surface and check the latter for minute cracks, etc.
Immediately replace the filter cartridge even in case of the most minor damage.
- If the filter cartridge is undamaged, place it at a location where the filter cartridge can be cleaned with compressed-air without endangering third parties and the environment.
- Blow out the filter cartridge with compressed-air from the inside outwards.
- Clean the filter housing. The remaining quantities of blasting material adhering in the filter housing are taken up by the filter bag.
- Empty the filter bag and subsequently secure it again in the funnel aperture of the filter housing using the tightening band.
- Reinsert the filter cartridge in the filter housing. Pay attention to correct seat and seal.
- Secure the filter cartridge again with the wing nuts.
- Subsequently reclose the filter housing using the clamping lever.

List of spare parts

- 1 - Injector-blasting nozzle, Ø 7 mm, made of hardened steel (Order no.: 0 952 011)
made of carbid Order no.: 0 952 022), with boron carbide insert (Order no.: 0 952 018)
- 2 - Injector cast part made of aluminium (Order no.: 0 952 016)
- 3 - Blasting shot hose Ø 13 mm, 2.5 metres long (Order no.: 0 952 081-3)
- 4 - Air nozzle, Ø 3.5 mm (Order no.: 0 952 010)
- 5 - Retaining ring HC1/4P9 (Order no.: 0 952 016-1)
- 6 - Hose nozzle ¼" x 13 mm (Order no.: 0 952 050)
- 7 - Machine lamp 11 watts, (Order no.: 0 952 070-1)
- 7a - Illuminant for machine lamp (Order no.: 0 952 070-3)
- 7b - Protective tube for machine lamp (Order no.: 0 952 070-2)
- 8 - Rotating rosette, 130 mm (Order no.: 0 952 054)
- 9 - Filter pressure control, ½" (Order no.: 0 952 055)
- 10 - Pressure gauge, Ø 40 mm (Order no.: 0 952 033)
- 11 - Plexiglas safety pane, 320 x 420 mm (Order no.: 0 952 027)
- 12 - Glass wearing pane, 320 x 420 mm, interior (Order no.: 0 952 026)
- 13 - Rubber sealing profile, angled (Order no.: 0 952 078)
- 14 - Foot switch, pneumatic (Order no.: 0 951 131)
- 15 - Door contact switch (Order no.: 0 951 132)
- 18 - Working grid, 2 parts
- 20 - Dust bag (Order no.: 0 952 037)
- 21 - Screw-on hinge
- 22 - Air hose, 8 mm (Order no.: 0 951 118-3)
- 24 - Fan motor
- 25 - optional blow-out gun (Order no.: 0 952 023)
- 26 - Gloves, integrated, size 10 (Order no.: 0 952 024)
- 26a - Gloves, size 9 (Order no.: 0 952 024-1)
- 26b - Tensioning strap for gloves (Order no.: 0 952 043)

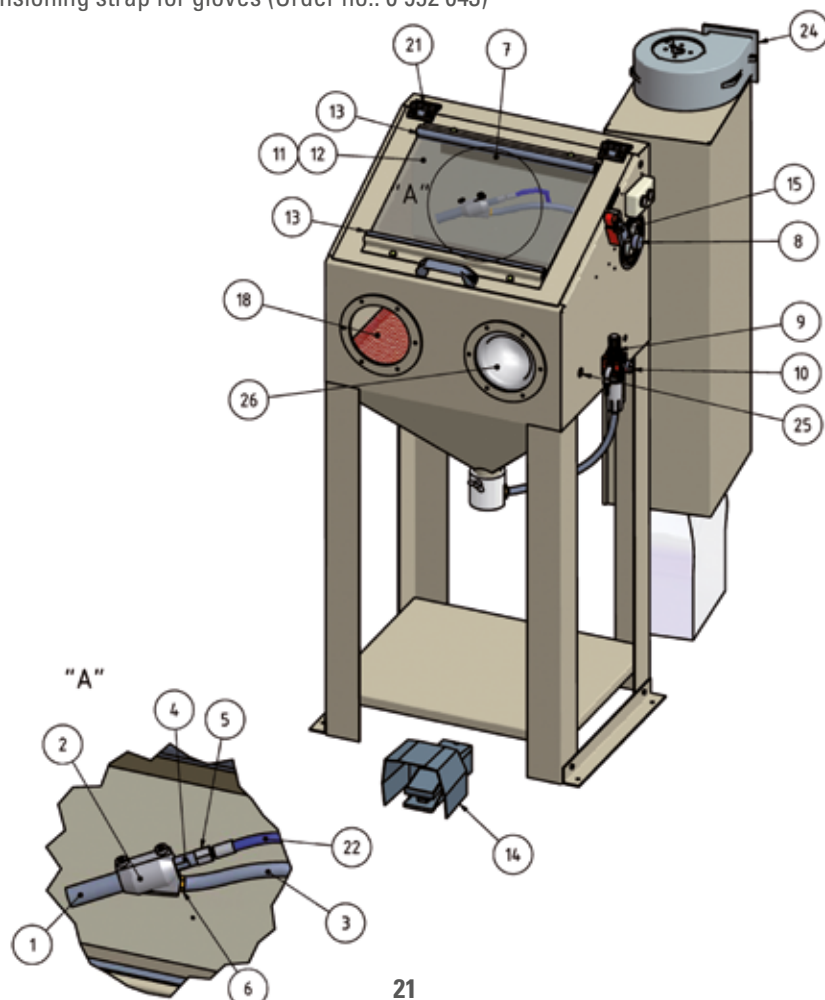

- 16 - Handle, plastic
- 17 - Run-off container with connection, $\frac{3}{4}$ " x 13 mm (Order no.: 0 952 056)
- 19 - Filter cartridge, 240 x 600 mm (Order no.: 0 952 012)
- 23 - Tensioning strap for dust bag, 590 mm long (Order no.: 0 952 043)

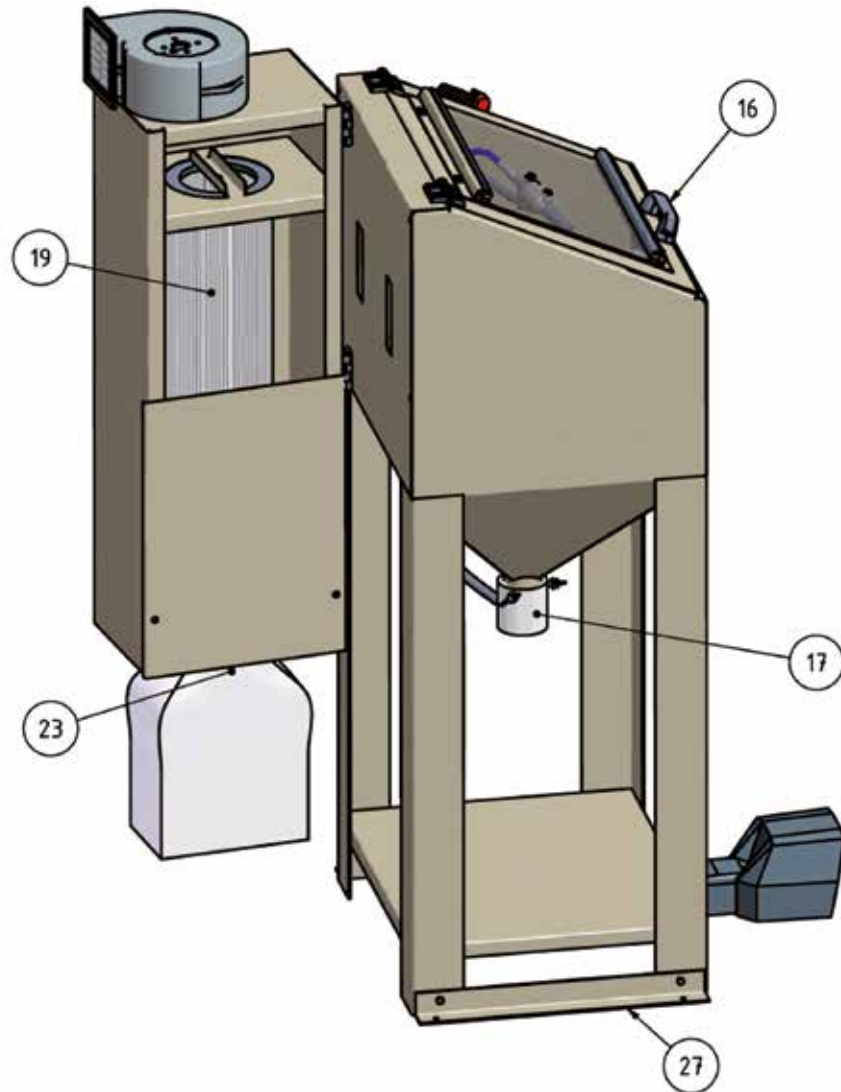

12 Conformity declaration

We, joke Technology GmbH
D-51429 Bergisch Gladbach
Asselborner Weg 14-16,

hereby declare that the design of the product

Fine blasting unit mikromat 50 eco

Serial-No. _____

have been developed, designed and manufactured following the EC guidelines/directives

- 2006/42/EG - Machinery**
- 2006/95/EG - Low voltage**
- 2004/108/EG - Electromagnetic compatibility**
- 97/23/EG - Pressure equipment.**

The following harmonized standards have been applied:

- DIN EN ISO 12100** - **Safety of machinery, devices and systems**
- DIN EN ISO 13857** - **Safety of machinery; safety distances to prevent danger zones from being reached**
- DIN EN 1248** - **Safety requirements for abrasive blasting equipment**
- DIN EN 61000-6-4** - **EMC emitted interference**
- DIN EN 61000-6-2** - **EMV interference immunity**
- DIN EN 60204-1:2007-06** - **Electrotechnology.**

The following national regulations have been applied:

- BGV D26** - **Blasting work.**

A complete list of applied standards, directives and specifications is available from the manufacturer. Technical documentation is available in full. The operating manual corresponding to the unit exists.

Authorised for documentation:

Kerstin Otto, joke Technology GmbH, Asselborner Weg 14-16, D-51429 Bergisch Gladbach

Authorized signatory:

Udo Fielenbach, joke Technology GmbH, Asselborner Weg 14-16, D-51429 Bergisch Gladbach



Udo Fielenbach, Managing Director

Bergisch Gladbach, 26. February 2016
Place, date



Brilliant solutions for perfect surfaces

joke Technology GmbH
Asselborner Weg 14 -16
D-51429 Bergisch Gladbach

Tel. +49 (0) 22 04 / 8 39-0

Fax +49 (0) 22 04 / 8 39-60

Mail info@joke.de

Web www.joke.de

Order no. for instruction manual: BA2036GB